

20 30 MAPLE

EL SEGUNDO, CA

15,000 - 75,000 RSF
OF TRANSFORMED INDUSTRIOUS
SPACE AVAILABLE

CONTACTS

STEVE SOLOMON
MANAGING DIRECTOR
+1 424 294 3434
steve.solomon@am.jll.com
CA LICENSE# 00956150

KRISTEN BOWMAN
VICE PRESIDENT
+1 424 294 3413
kristen.bowman@am.jll.com
CA LICENSE# 01951586



GROUND FLOOR

HYPOTHETICAL TWO TENANT DEMISING PLAN

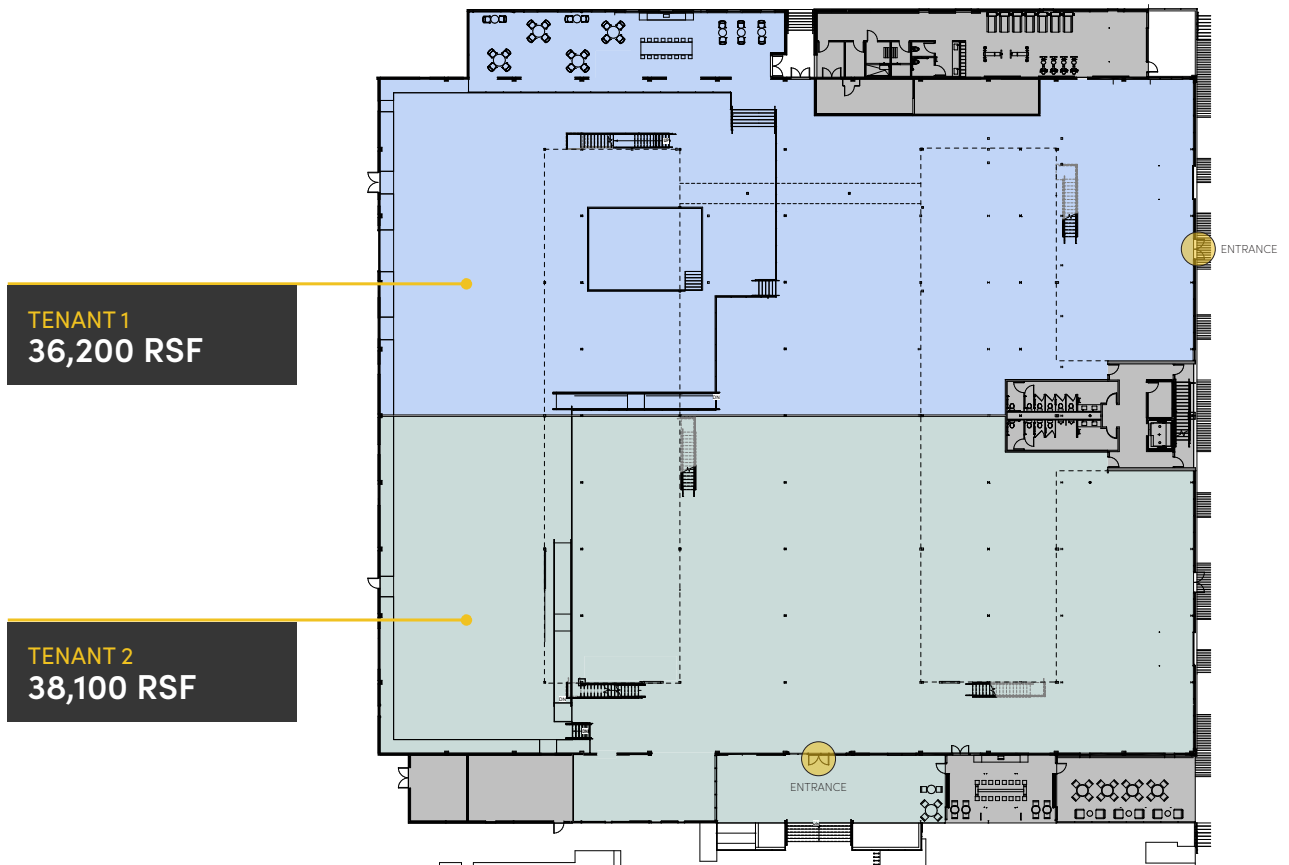

20 30 MAPLE

EL SEGUNDO, CA

15,000 - 75,000 RSF
OF TRANSFORMED INDUSTRIOUS
SPACE AVAILABLE

CONTACTS

STEVE SOLOMON
MANAGING DIRECTOR
+1 424 294 3434
steve.solomon@am.jll.com
CA LICENSE# 00956150

KRISTEN BOWMAN
VICE PRESIDENT
+1 424 294 3413
kristen.bowman@am.jll.com
CA LICENSE# 01951586

MEZZANINE

HYPOTHETICAL TWO TENANT DEMISING PLAN

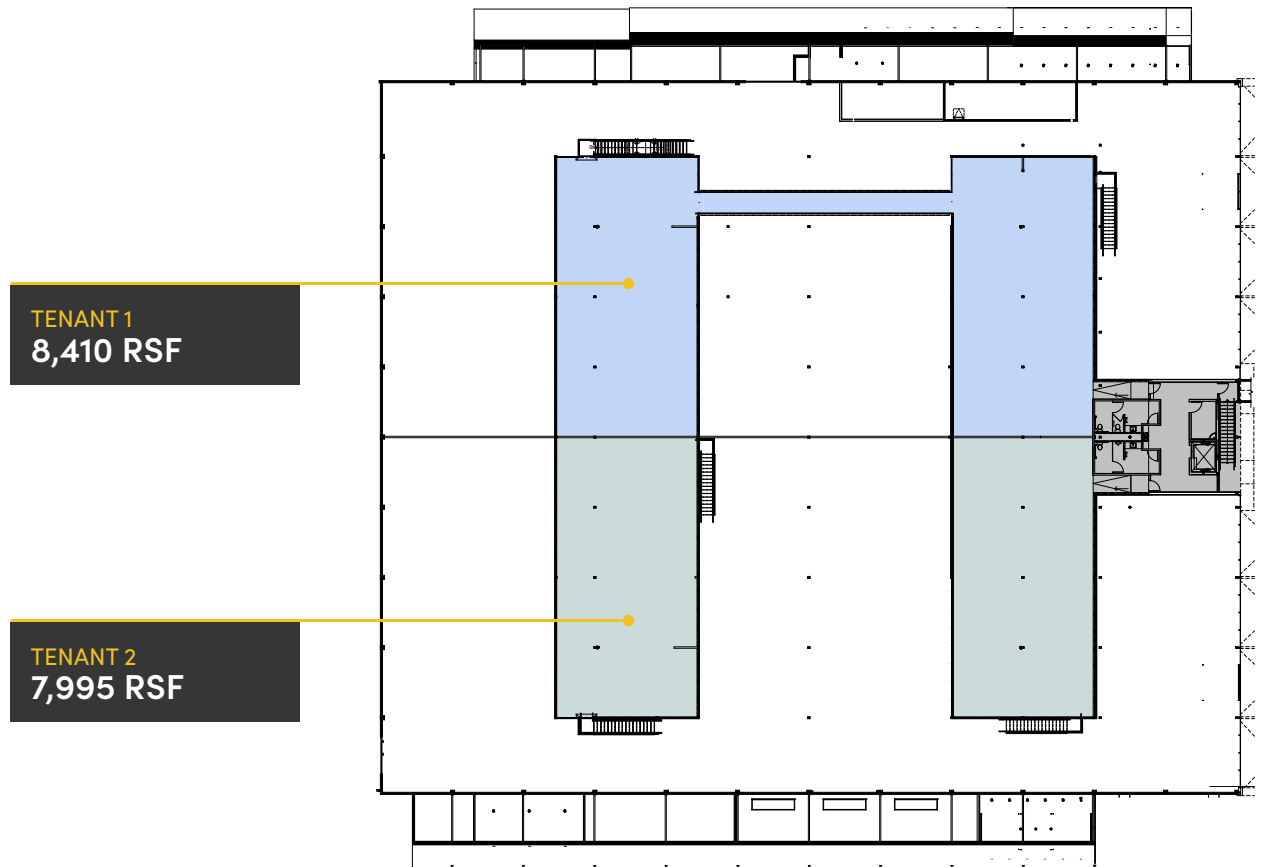

20 30 MAPLE

EL SEGUNDO, CA

15,000 - 75,000 RSF
OF TRANSFORMED INDUSTRIOUS
SPACE AVAILABLE

CONTACTS

STEVE SOLOMON
MANAGING DIRECTOR
+1 424 294 3434
steve.solomon@am.jll.com
CA LICENSE# 00956150

KRISTEN BOWMAN
VICE PRESIDENT
+1 424 294 3413
kristen.bowman@am.jll.com
CA LICENSE# 01951586



GROUND FLOOR

HYPOTHETICAL THREE TENANT DEMISING PLAN

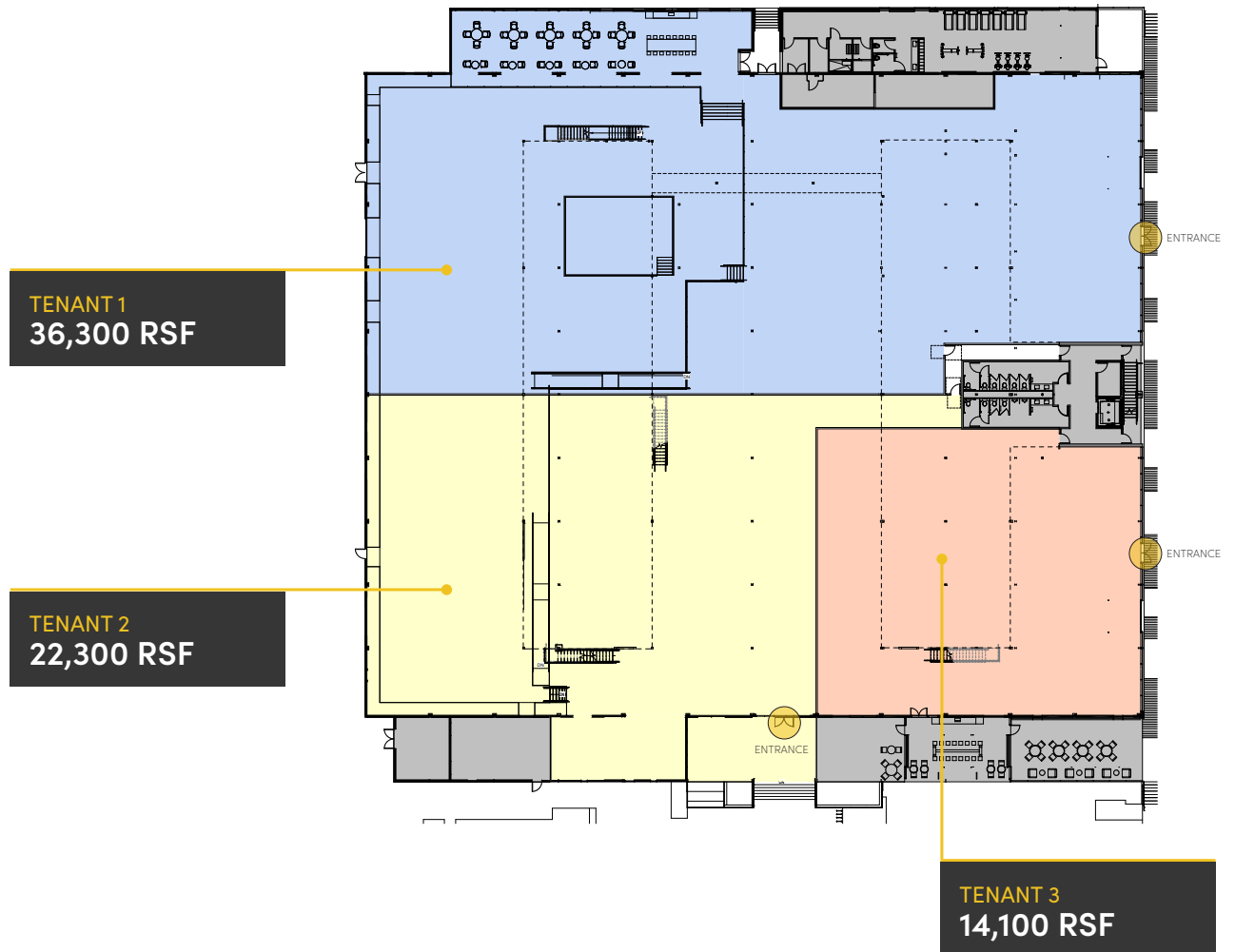

20 30 MAPLE

EL SEGUNDO, CA

15,000 - 75,000 RSF
OF TRANSFORMED INDUSTRIOUS
SPACE AVAILABLE

CONTACTS

STEVE SOLOMON
MANAGING DIRECTOR
+1 424 294 3434
steve.solomon@am.jll.com
CA LICENSE# 00956150

KRISTEN BOWMAN
VICE PRESIDENT
+1 424 294 3413
kristen.bowman@am.jll.com
CA LICENSE# 01951586



MEZZANINE

HYPOTHETICAL THREE TENANT DEMISING PLAN

